

NGRS AGM WEEKEND 13TH & 14TH MAY 2017

PARKING DIRECTIONS AND LATEST NEWS.



Members travelling to the area on Friday 12th May may be interested in the following narrow gauge railway related events:

Apedale Valley Light Railway (Moseley Railway Trust) are holding a steam gala over the weekend with photographer's passes available to include access on the Friday. See their website for details <http://www.mrt.org.uk/>, Additionally venerable Ffestiniog loco "Palmerston" will be visiting Liverpool's Albert Dock <http://www.albertdock.com/> for Steam on the Dock, and will be in steam every day from 6th-14th May, giving rides in heritage carriages.

Saturday 13th May

West Lancs Light Railway and NGRS AGM.

From Preston and M6 follow A59 towards Southport. After crossing the bridges over a river and canal on a right hand bend take the next right at traffic lights signed Tarleton and Hesketh Bank. After approx 1.5 miles pass the railway on the right and continue to the church hall, which is also on the right.

Please park (free) at All Saints Church Hall, Station Road, Hesketh Bank, PR4 6SQ. The AGM will take place in the hall at 3pm, and the railway is a short walk way. There is very limited parking for those of limited mobility at the railway itself. (Sat Nav Co-ordinates: 53.702419, -2.840426)

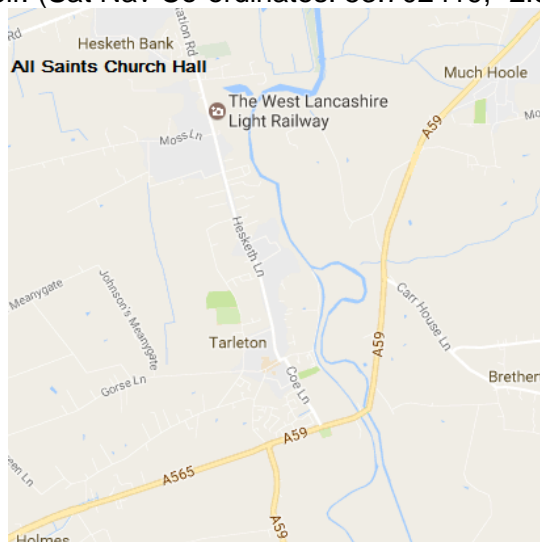

Lakeside Miniature Railway, Southport

Retrace your steps to the A59 and turn right, then follow A565 towards Southport. At the major roundabout as you enter Southport follow signs to Marine Drive. Follow Marine Drive for 4 miles then turn left into the Ocean Plaza car park (free for 2 hours and after 6pm), just before you reach the pier. The LMR station is adjacent to Marine Parade, opposite McDonald's and Pizza Hut. Nearest postcode PR8 1SA. **Please note that this is different to the postcode given in the AGM details** which is for the other end of the line. A rail shuttle service will operate to take our party to the sheds for the guided tour. (Sat Nav Co-ordinates: 53.652266, -3.012572)



Evening meal at the Hesketh Arms, Churchtown, Southport

Follow one of the routes shown to The Hesketh Arms, Botanic Road, Southport, PR9 7NA. (Sat Nav Co-ordinates: 53.659681, -2.961776)

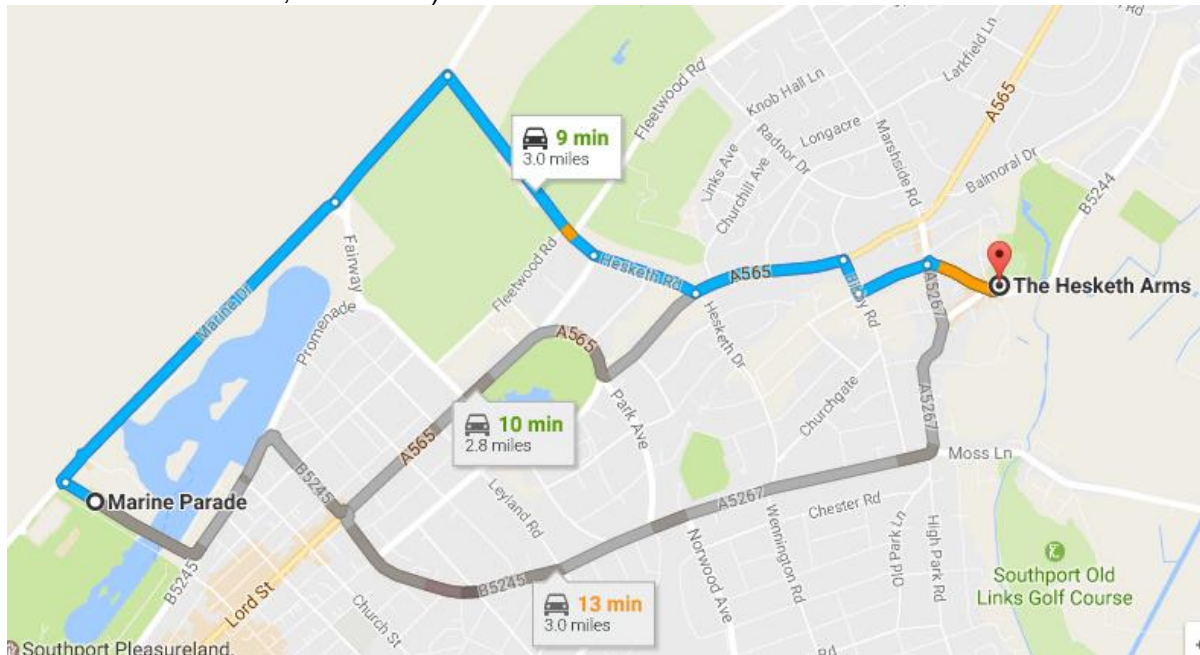

Southport Pleasureland.

Sunday 14th May Windmill Farm Railway

There is ample free parking in the Farm's car park, adjacent to the railway. Fish Lane, Burscough, L40 1UQ. Enter through the normal entrance to the farm attractions but of course no need to pay an entrance fee. Windmill Farm is signed on brown tourist signs from various locations, as is the Martin Mere Wetland Centre, just half a mile South of the railway. From Southport take the A565 to Mere Brow, turn right along B5246. After about a mile turn right into Wiggins Lane (brown signs). Windmill Farm is on the right after half a mile. (Sat Nav Co-ordinates: 53.633359, -2.866558)

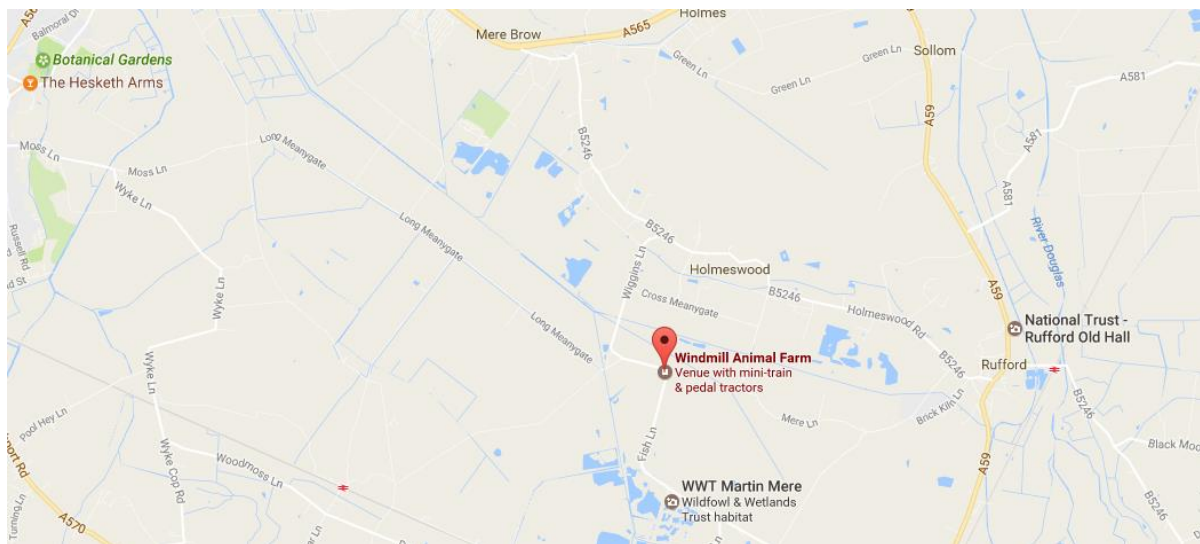

Extra visit! The NGRS has been invited to visit a workshop in Leyland where Baldwin 4-6-0 BLW 45190/WDLR 608 is undergoing restoration.

We will be given a presentation on some of the challenges faced in this project, and will be served teas/coffees and cakes. In order to fit this visit in we will start lunch a little earlier and skip dessert at Windmill Farm in favour of cake with the Baldwin. The visit to the Worden Park track will start a little later too. The workshop is at 3, Midge Hall Lane, Midge Hall Leyland PR26 6TN. Since there are no brown signs the directions are:

Return to B5246 and then either travel North West to the A565 at Mere Brow or east to the A59 at Rufford. At Tarleton traffic lights (junction of A565 and A59) take A59 towards Preston for about one mile. Turn right at roundabout onto the B5247 Carr House Lane (signposted Leyland and Chorley). After about half a mile turn left onto B5248 North Road - becomes Dunkirk Lane later on (signposted Leyland). Immediately on entering the western outskirts of Leyland, turn left onto Longmeanygate (signposted Longton and Midge Hall). After about half a mile turn left onto Midge Hall Lane (signposted Longton and New Longton). After about 100 metres and immediately before the sharp left-hand bend, there is a white house (and green

workshop) on the left - turn into the driveway and park (plenty of parking space). (Sat Nav Co-ordinates: 53.701821, -2.742281)

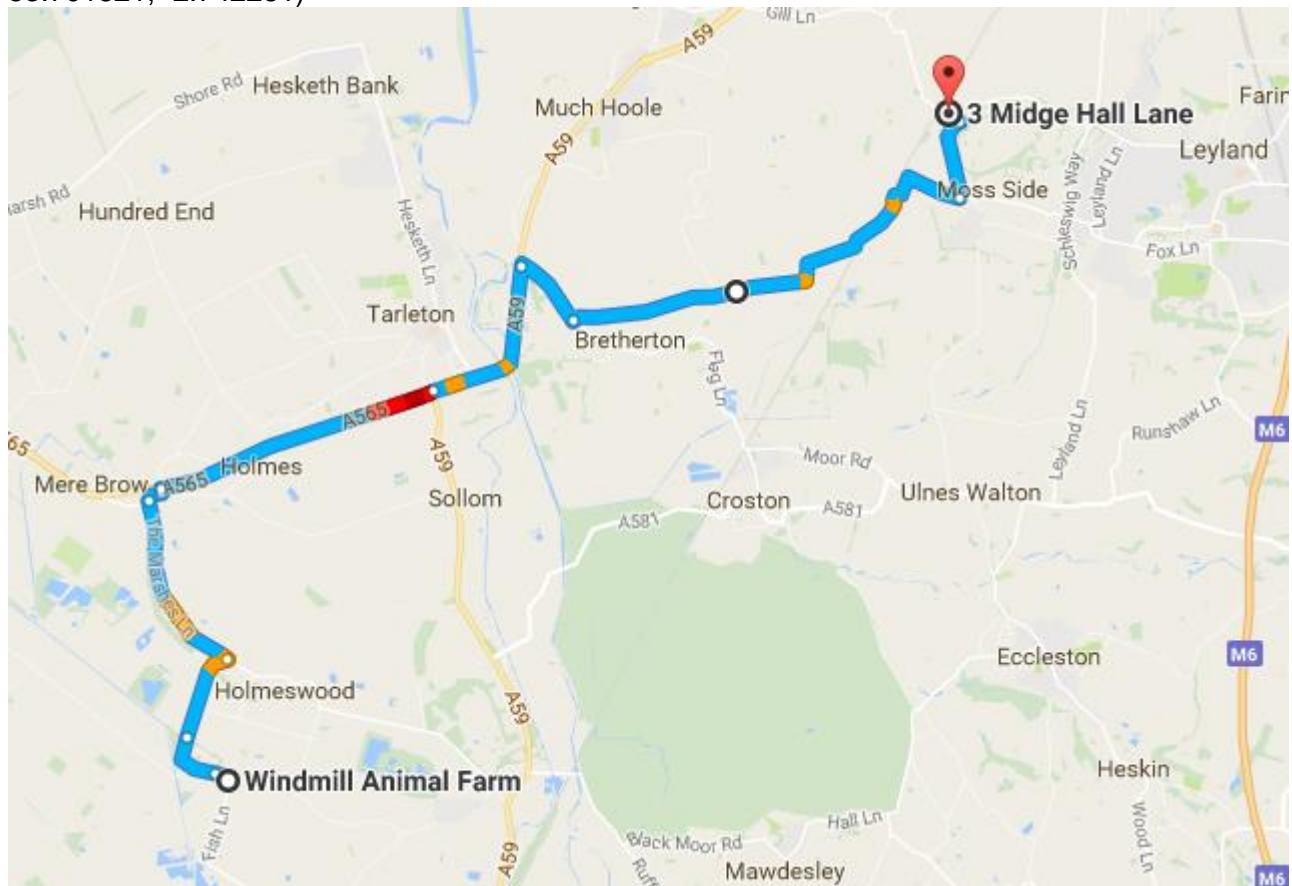

Leyland Society of Model Engineers

The club track is situated in Worden Park (public). Worden Lane, Leyland, Lancashire, PR25 3DH. The park has a large car park which is free to use, but which is likely to be quite busy if the weather is nice as the park is very popular with locals. Worden Park is signed from many places in Leyland. (Sat Nav Co-ordinates: 53.683872, -2.694411)

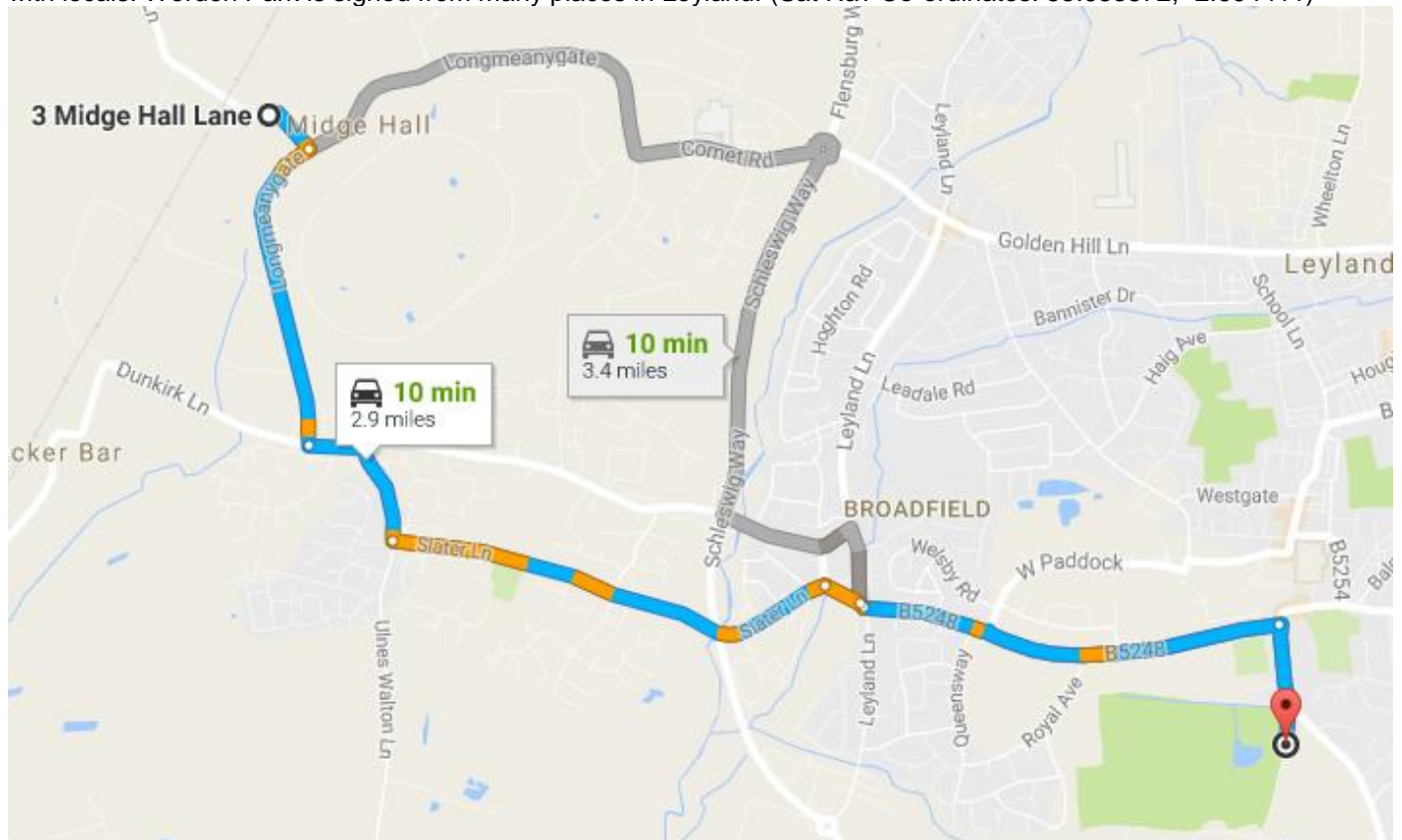

From the main car park walk about 200m SW. This will come out along the path marked "Entrance from Worden Lane" in the site map below. Turn right at the pond then keep on to the entrance to the LSME

compound. There is parking for disabled badge holders close to the compound which is reached by following the same route.

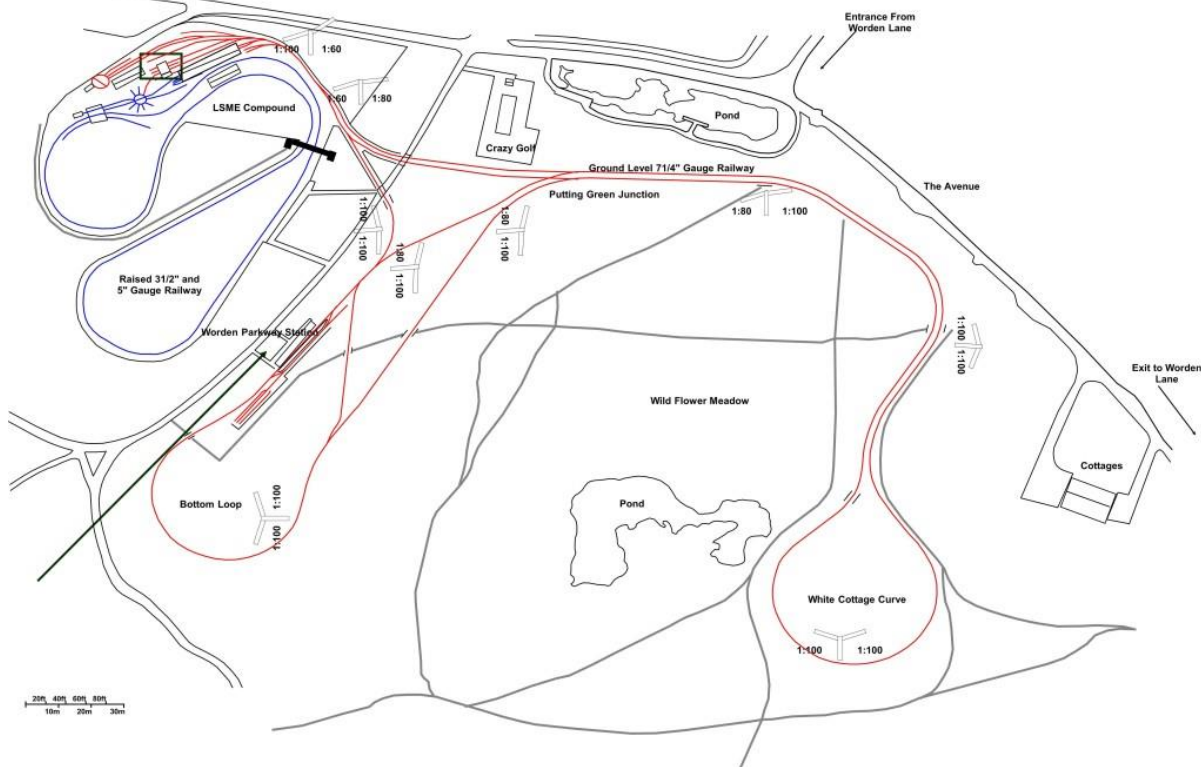

Haigh Hall Miniature Railway

This railway is situated in another popular public park. Follow one of the suggested routes to the entrance from New Road, on the East side of the park. Haigh Woodland Park, Haigh, Wigan, WN2 1PF. (Sat Nav Co-ordinates: 53.566314, -2.601331). We have been granted permission to park in the Model Engineers car park which is free of charge and close to the 15" gauge railway station. However the space available is very limited, especially as the model engineers are likely to be on site on a Sunday afternoon. Please share where possible. The alternative is to use the public pay and display car park (WN2 1PE) and walk in approximately 500m. The walking route takes you past the hall and café, however the latter will probably be about to close as we arrive. (Sat Nav Co-ordinates: 53.574227, -2.610307)

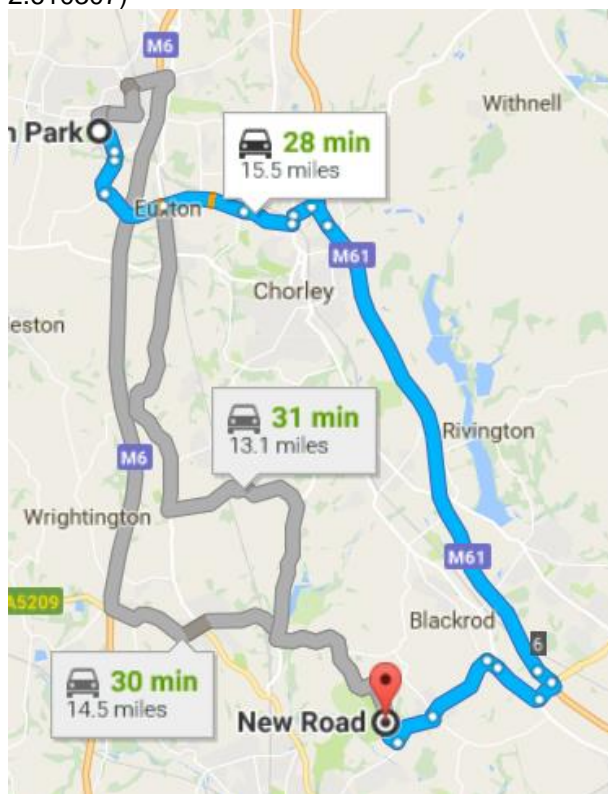

The map at right, above, shows the layout of the park. Note that it is not possible to drive between the two parking locations through the park, you would have to use the public roads outside the park. We should have a close idea of the number of available car spaces on the day and will direct members accordingly.